

## BD2000 Bactericidal Kitchen Cleaner



BD2000 is based on the Holchem Groups' proprietary Holquat technology. It has been specially formulated as a bactericidal cleaner for use on all kitchen and food preparation work surfaces. Safe to use on most stainless steel, plastic and ceramic tiled surfaces. BD2000 is a combined detergent & disinfectant, perfume-free to ensure no risk of tainting. Supplied in a concentrate or ready to use formula.

### Concentrated formulation:

2x5L Code: LEGM-2213-2NEX  
25L Code: LEGM-2213-25L

### Ready to use formulation:

2x5L Code: LEGM-2171-2NEX  
6x1L Code: LEGM-2171-SSW



Passes EN1276,  
EN1650, EN13697



### How To Use

BD2000 has excellent degreasing and bactericidal properties. BD2000 is effective against food poisoning bacteria, including E.coli. BD2000 is perfume-free, making it ideal for use in the food service industry. Fully biodegradable, BD2000 presents no effluent problems.

**WARNING: BD2000 is not suitable for use on soft metals such as zinc, copper and aluminium.**

**The ready to use formulation should be used as supplied, do not dilute.**

### DIRECTIONS FOR USE:

**Dilution rate:** Dilute BD2000 Concentrate 25:1 with clean water into a trigger spray bottle. BD2000 ready to use formulation (RTU) must not be diluted.

**Cleaning:** Spray the diluted BD2000 Concentrate/ RTU solution directly onto the surface to be cleaned and allow the product to penetrate the soiling. Wipe with a clean damp cloth or paper towel. For stubborn soiling, a second application may be required.

**Surface Disinfection:** Clean the surface as instructed above, then spray the diluted BD2000 Concentrate / RTU solution over the cleaned surface. Allow a minimum of 60 seconds contact time. Wipe with a clean damp cloth or paper towel, leave to air dry.

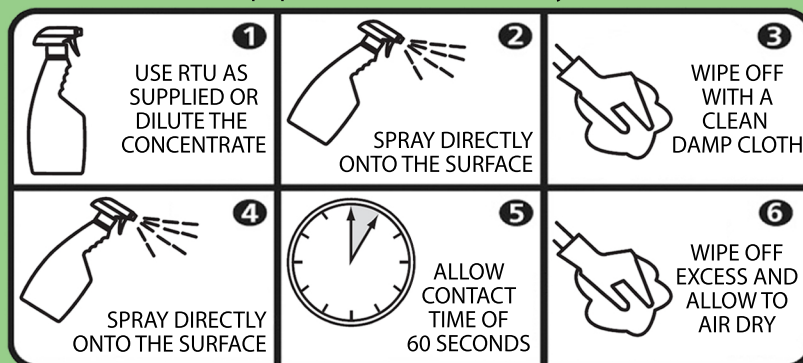

### HEALTH & SAFETY

Please refer to the MSDS for full health and safety information.



**DO NOT INGEST**  
**DO NOT MIX WITH OTHER CHEMICALS**  
**KEEP OUT OF REACH OF CHILDREN**